

## ALVA PENDANT

700TDALVP

### General Product Information

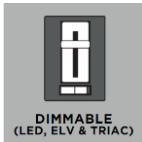
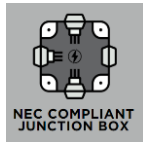
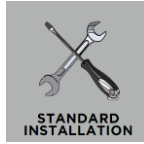

### Suggested/Required Tools



### Safety Information

#### CAUTION-RISK OF FIRE

This product must be installed in accordance with the applicable installation code by a person familiar with the construction and operation of the product and the hazards involved.

USE MINIMUM 90°C SUPPLY CONDUCTORS.



Turn off electrical current at the source before working with any lighting fixture or portable lamp.

Install and use this product in adherence with local electrical codes and regulations.

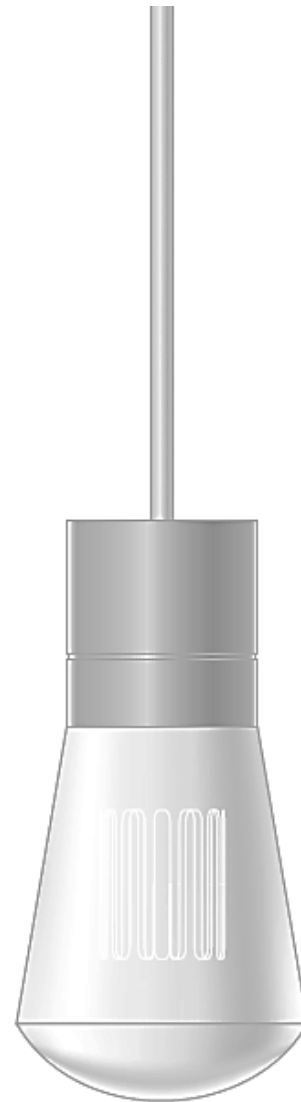

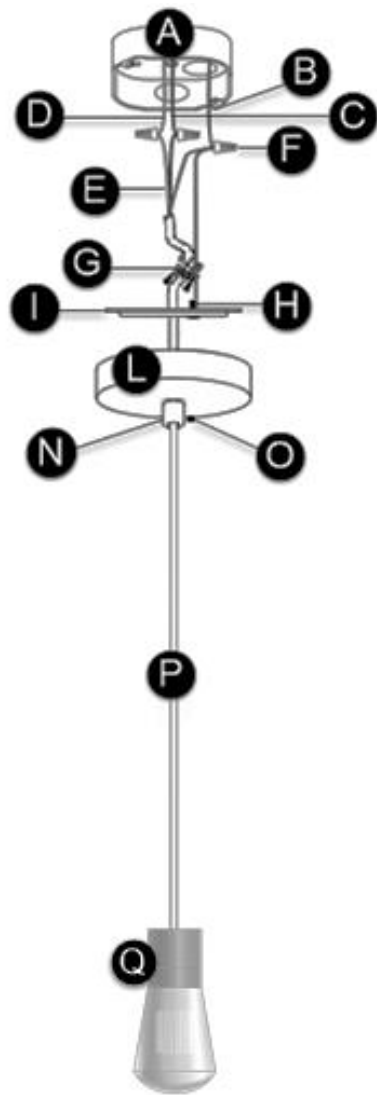

## FIXTURE PARTS

- A. Junction box
- B. Power Line Ground Wire
- C. Power Line Neutral (-) Wire
- D. Power Line Hot (+) Wire
- E. Fixture Wires
- F. Wire Nuts/Wire Nut Connections
- G. Secondary Strain Relief with Tabs
- H. Green Ground Screw
- I. Mounting Bar
- J. Mounting Bar Center Hole
- K. #8-32 Screws (2)
- L. Canopy
- M. Canopy Center Hole
- N. Strain Relief
- O. Set Screw
- P. Fixture Cord
- Q. Fixture

## INSTRUCTIONS

### I. Preparing the Canopy

1. Carefully unbox and examine all the items included in the packaging of the pendant.
2. Locate the canopy and completely unscrew the strain relief from it to remove the mounting bar.
3. Secure the mounting bar to the junction box using the provided #8-32 screws.

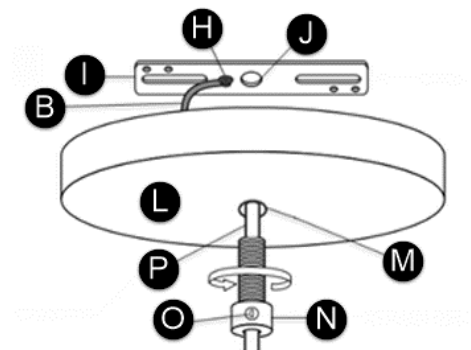
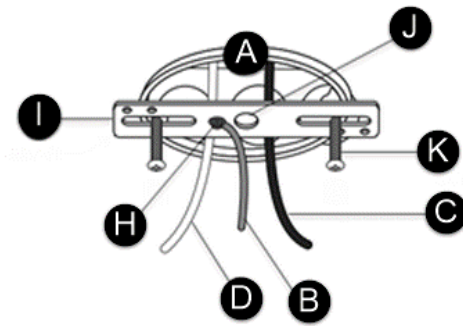

4. Loosen (do not remove) and back out the set screw on the strain relief using a small flathead screwdriver. If removed, the screw is difficult to reinsert and can be easily lost.

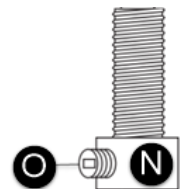

## II. Adjusting the Fixture Cord Length

1. Do the following to determine the ideal cord height for the pendant:

**Note:** If the fixture has a cloth-covered cord, tape the end of the cord to make it easier to feed through the strain relief and peel back or remove the cloth at the point where the secondary strain relief is installed.

- a) Feed the cord through the canopy and strain relief.
  - b) Adjust the fixture height by moving the canopy and strain relief up or down until the desired height is reached (measured from the bottom of the fixture shade to the top of the canopy).
  - c) Once height is set, tighten the set screw on the strain relief.
  - d) Mark the cord just beneath the strain relief for reference.
2. Leave approximately 6" of cord behind the canopy for wiring connections. Trim any excess cord.
  3. Carefully strip 4" of the cord insulations, avoiding damage to the inner wires.

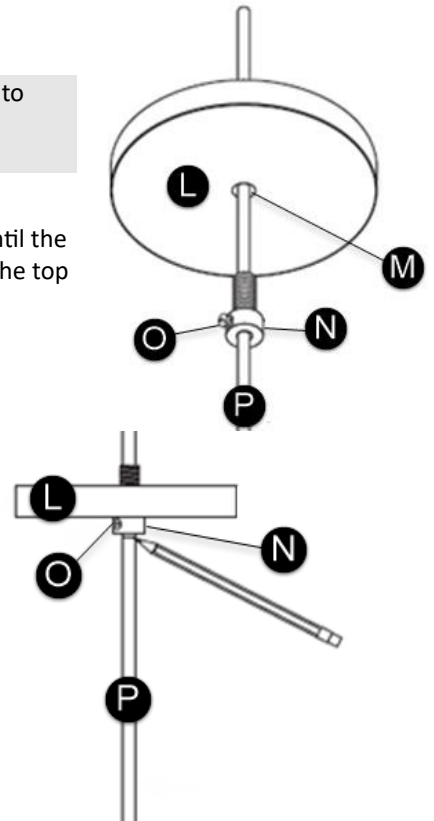
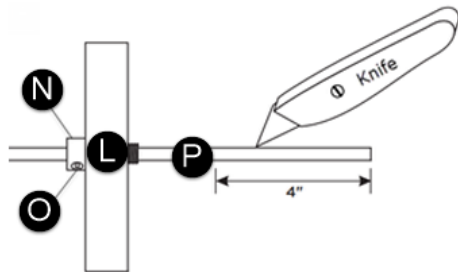

## III. Wiring the Fixture

1. Safety first! Locate the circuit breaker and switch it off to cut off the power supply to the relevant circuits, ensuring there's no electricity running through the wiring.
2. Feed the fixture wires through the center hole of the mounting bar, pulling them into the junction box.
3. Install the secondary strain relief and feed the cord through it.

**Note:** The secondary strain relief installation only applies to fixtures that are supplied with one. If not applicable, skip this step.

4. Snap the secondary strain relief tab into place.
5. Pull the cord to remove slack and fit the cord into the openings of the secondary strain relief.
6. In accordance with local electrical codes, connect the fixture ground wire (bare copper or silver wire) to a suitable ground. This may be a green ground screw on the mounting plate, to which the ground wire should be tightly wrapped, or to a house wire (green or bare copper wire without insulation).
7. Adjust the wire length using a wire stripper/cutter, if needed.
8. Twist the bare ends of the following pairs of wires together using a wire nut to secure a connection:
  - a) Hot fixture wire to hot (black) power line wire
  - b) Neutral fixture wire to neutral (white) power line wire
9. Carefully tuck all the wires between the canopy and the junction box.

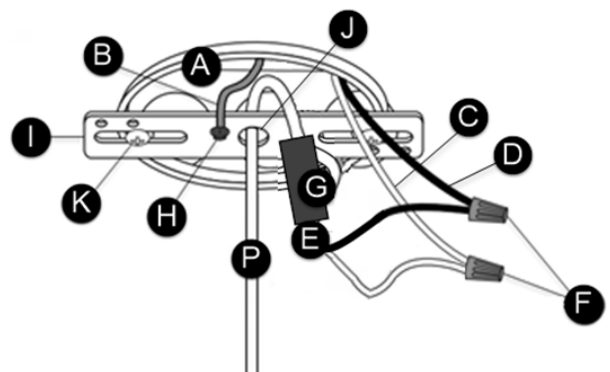
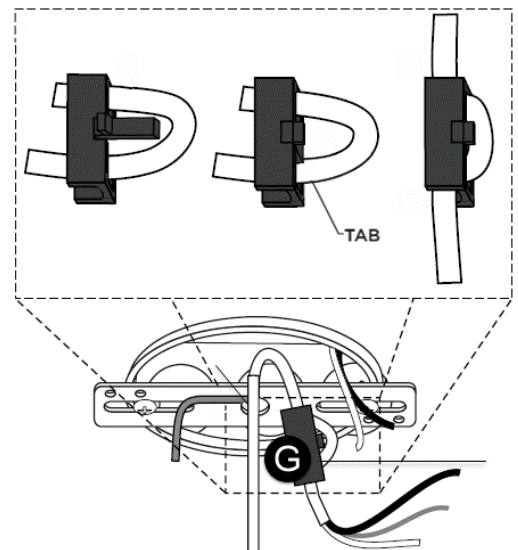

#### IV. Installing the Fixture

 Recommendation: One person should hold the fixture while another performs the final canopy installation.

1. Loosen the set screw again on the strain relief.
2. Align the center hole on the canopy with the center hole in the mounting bar.
3. Slide the canopy flush against the ceiling and tighten the strain relief into the mounting bar to secure — avoid twisting the cord.
4. Push any excess cord into the canopy and align the previously marked point on the cord with the bottom of the strain relief.
5. Tighten the set screw to secure the cord position.
6. Ensure all components are secure.
7. Perform a final safety check of all connections before powering the fixture on to test it.

